

# WIRING INSTRUCTIONS

TITLE

**SUPER HOLE-SHOOTER**

**BULLETIN**

MILWAUKEE ELECTRIC TOOL CORP. 13135 WEST LISBON RD. BROOKFIELD, WIS.

DATE  
Dec. 2010

**58-01-0941**

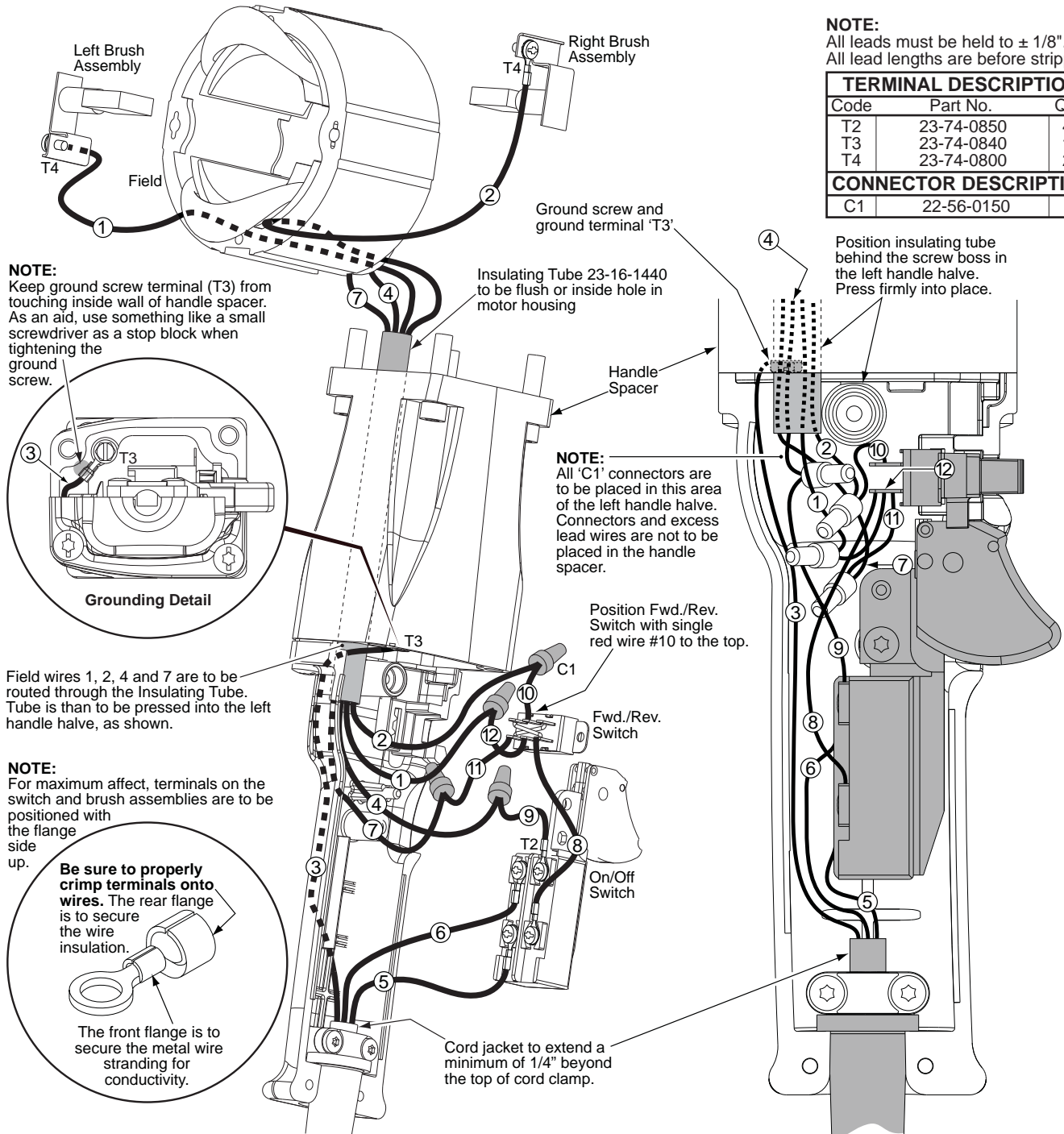

**NOTE:**  
All leads must be held to  $\pm 1/8"$ .  
All lead lengths are before stripping.

TERMINAL DESCRIPTION		
Code	Part No.	Qty.
T2	23-74-0850	4
T3	23-74-0840	1
T4	23-74-0800	2

CONNECTOR DESCRIPTION		
Code	Part No.	Qty.
C1	22-56-0150	4

## WIRING SPECIFICATIONS

Wire No.	Wire Color	Origin or Part No.	Gauge	Length	Terminals, Connectors and End Wire Preparation
1	White	Field	-----	-----	Connect terminal 'T4' to left brush assembly. Join stripped end with white wire #12 & terminate with 'C1'.
2	Red	Field	-----	-----	Connect terminal 'T4' to right brush assembly. Join stripped end with red wire #10 & terminate with 'C1'.
3	Green	Cord	-----	-----	Connect 'T3' of the ground wire to the bottom of handle spacer. See grounding detail.
4	Black	Field	-----	-----	Join with stripped end of black wire #9. Terminate both wires with connector 'C1'.
5	White	Cord	-----	-----	Connect terminal 'T2' to lower left position of on-off switch.
6	Black	Cord	-----	-----	Connect terminal 'T2' to upper left position of on-off switch.
7	Yellow	Field	-----	-----	Join with stripped end of yellow wire #11 from fwd./rev. switch. Terminate together with connector 'C1'.
8	Black	23-66-2517	-----	-----	Connect terminal 'T2' to lower right position of on-off switch.
9	Black	23-94-8050	-----	-----	Join stripped end of jumper wire to black wire #4. Terminate with 'C1'. Connect 'T2' to upper right of switch.
10	Red	23-66-2517	-----	-----	Join with stripped end of red wire #2. Terminate both wires together with connector 'C1'.
11	Yellow	23-66-2517	-----	-----	Join with stripped end of yellow wire #7. Terminate both wires together with connector 'C1'.
12	White	23-66-2517	-----	-----	Join with stripped end of white wire #1. Terminate both wires together with connector 'C1'.